

North East and Yorkshire and the Humber Adult Mental Health
Clinical Network

Early Intervention in Psychosis Network

17 September 2020



Early Intervention in Psychosis
Achieving *Ordinary Lives*

NHS England and NHS Improvement



Housekeeping

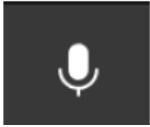

Please remain on mute throughout the session, unless invited to speak – thank you.



You are welcome to use the video function, however this occasionally causes bandwidth problems so you may wish to turn it off.

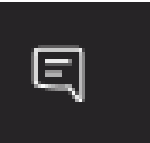

Whilst we will have an open conversation, please *feel free to use the chat box function* to ask questions or make comments.

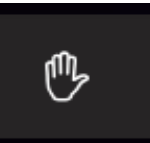

If you would like to speak please use the “Put Hand Up” function and the moderator will come to you in due course.

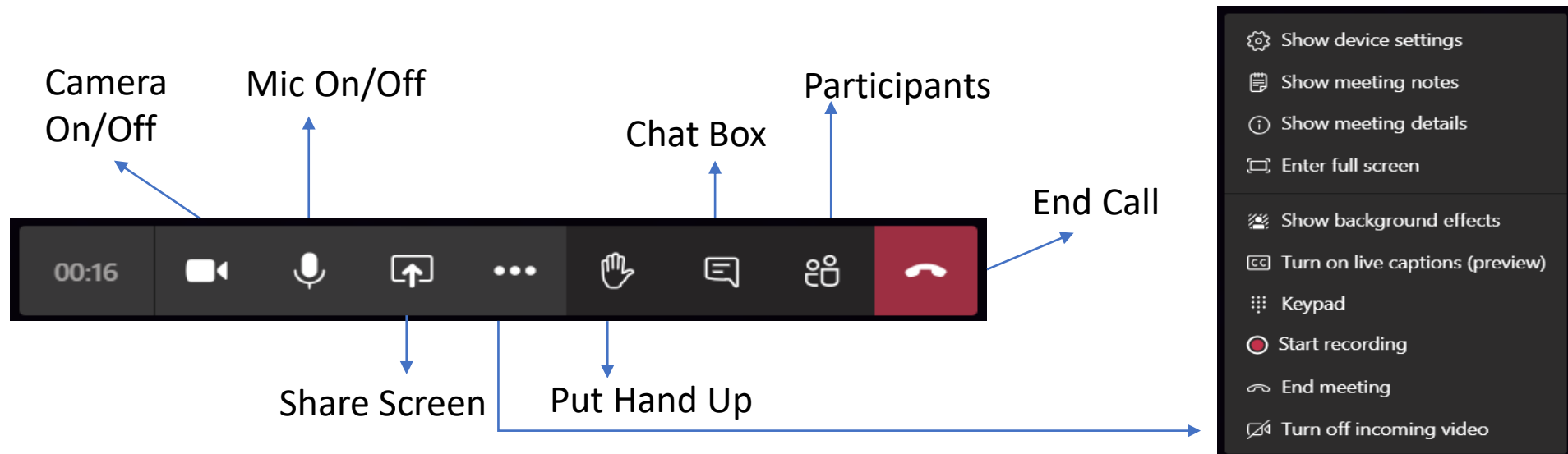

Slido



At today's meeting we are going to use Slido to allow people to take part in interactive polls.

You just need to follow a two easy steps and then you will be ready to participate:

1. In the internet browser on your phone, tablet or laptop open: www.slido.com
2. Enter code: #YHEIP

Agenda



12:30	Welcome, Introductions, Housekeeping and Introduction to Slido	Denise Friend, Quality Improvement Lead, Yorkshire and the Humber Clinical Networks
12:35	Update on the Phase 3 recovery planning for EIP, Long Term Plan ambitions, new guidelines, NCAP Audit and training	Moggie McGowan, Co-Chair, Clinical Advisor, Y&H IRIS, Y&H Clinical Network & NHS England North
13:00	Introduction to the Group Discussion	Dr Steve Wright, Co-Chair, Consultant Psychiatrist, TEWV & Clinical Advisor, Y&H Clinical Network
13:10	Group Discussion: Peer Workers and Increasing Service User and Carer Participation in EIP	Vicky Haywood, Barnsley EIP / Zafar Iqbal and Bob Collins, Bradford EIP / All
13:45	Listening to the Network (Slido Session)	All
13:55	Summary and Close	Dr Steve Wright, Co-Chair, Consultant Psychiatrist, TEWV & Clinical Advisor, Y&H Clinical Network
14:00	Close	

North East and Yorkshire and the Humber Adult Mental Health
Clinical Network

Early Intervention in Psychosis Network

Update on the Phase 3 recovery planning for EIP, Long Term
Plan ambitions, new guidelines, NCAP Audit and training

Moggie McGowan, Co-Chair, Clinical Advisor, Y&H IRIS, Y&H Clinical
Network & NHS England North

17 September 2020



Early Intervention in Psychosis
Achieving *Ordinary Lives*

NHS England and NHS Improvement



Implementing phase 3 of the NHS response to the COVID-19 pandemic

NEYH EIP Summary

Classification: Official

[Publications approval reference: 001559](#)



Implementing phase 3 of the NHS response to the COVID-19 pandemic

7 August 2020

Implementing phase 3 of the NHS response to C-19 in Mental Health

- The third phase of the NHS response to COVID-19 focuses on accelerating the return to near-normal levels of non-COVID health services.
- Systems have been asked to validate their plans to deliver the mental health transformation and expansion programme over the next eight months.
- This guidance supersedes the prioritisation guidance for community health services first published on 20 March 2020 and updated on 2 April 2020, which is withdrawn.

Mental Health Planning

- Allocating the additional funding required to meet the MHIS
- Our priority is to maintain momentum and continue to deliver the LTP.
- It continues to be a requirement that the Mental Health Investment Standard (MHIS) is met in every CCG in 2020/21.
- The total annual allocations for all Transformation Funding (SDF) programmes in 2020/21 remains in place and sites should proceed with delivery
- We need to grow services, recruit staff and make the necessary changes to ensure we still meet the ambitions outlined in the NHS Long Term Plan (LTP).
- We will be repeating the independent audits of the MHIS and we expect to see historic underinvestment in Mental Health addressed in every CCG.

Contracting 20/21

- Phase 3 Mental Health planning process: ICS/STP leads and a lead MH Provider will sign off Phase 3 plans, confirming that the MHIS investment covers **all** the priority areas for the programme.
- STPs/ICSs should strive to achieve the specific deliverables for 2020/21 set out in the **NHS Mental Health Implementation Plan 19/20–23/24**
- The specific LTP deliverables for EIP in 2020/21 are to:
 - (i) Achieve the 60% EIP Access Standard
 - (ii) Achieve 60% Level 3 NICE concordance.
- Closes on 21 September, with an interim submission on 1 September

Adult Severe Mental Illness Community Care – national funding profile



- There is £52m worth of ringfenced Mental Health investment to be used for EIP in 2020/21. This investment is not predicated on savings.
- All areas are expected to use LTP investment for ARMs, over 35s and to improve NICE concordance. Intelligence from clinical network deep dives has shown that where investment has not grown in line with national uplift services can struggle to meet the quality standard.
- **To access CCG and STP level indicative investment profiles for community SMI please ask your Regional MH Lead for access to the ‘Mental Health LTP analytical tool’ workspace on the Future NHS Collaboration Platform**

Five-year profile for the FYFVMH and LTP (£m in cash terms)			Baseline	Year 1	Year 2	Year 3	Year 4	Year 5	
			2018/19	2019/20	2020/21	2021/22	2022/23	2023/24	
Adult Severe Mental Illnesses (including care for people with eating disorders, mental health rehabilitation needs and a ‘personality disorder’ diagnosis)	Early Intervention in Psychosis	Central / Transformation	0	0	0	<i>Funding for each of these commitments is included in ‘Adult Mental Health (SMI) Community Care Total’ from 2021/22 onwards</i>			
		CCG baselines	12	18	52				
		Total	12	18	52				
	Individual Placement and Support	Central / Transformation	13	30	23				
		CCG baselines	0	0	0				
		Total	13	30	23				
	Physical health checks for people with Severe Mental Illnesses	Central / Transformation	0	0	0				
		CCG baselines	2	51	79				
		Total	2	51	79				
	New integrated community models for adults with SMI (including care for people with eating disorders, mental health rehabilitation needs and a ‘personality disorder’ diagnosis)	Central / Transformation	0	31	52				
		CCG baselines	0	33	135				
		Total	0	65	187				
	Adult Severe Mental Illnesses (SMI) Community Care	Central / Transformation	13	61	75		147	370	456
		CCG baselines	14	103	265		279	326	519
Total		27	165	341	426	696	975		

Adult Severe Mental Illness Community Care – LTP delivery requirements



Ambition	2019/20	2020/21	2021/22	2022/23	2023/24
	Fixed				
Integrated primary and community care for adults and older adults with SMI access	Stabilise and bolster core community mental health teams <i>[Testing new model within select number of STPs/ICSs]</i>	Stabilise and bolster core community mental health teams <i>[Testing new model within select number of STPs/ICSs]</i>	At least 126,000 adults and older adults with SMI (including care for people with eating disorders, mental health rehabilitation needs and a 'personality disorder' diagnosis) receiving care from integrated primary and community mental health services	At least 257,000 adults and older adults with SMI (including care for people with eating disorders, mental health rehabilitation needs and a 'personality disorder' diagnosis) receiving care from integrated primary and community mental health services	At least 370,000 adults and older adults with SMI (including care for people with eating disorders, mental health rehabilitation needs and a 'personality disorder' diagnosis) receiving care from integrated primary and community mental health services
SMI physical health checks	A total of 280,000 people receiving physical health checks <i>[FYFVMH commitment]</i>	A total of 280,000 people receiving physical health checks <i>[FYFVMH commitment]</i>	A total of 302,000 people receiving physical health checks <i>[An additional 22,000 above FYFVMH ambition]</i>	A total of 346,000 people receiving physical health checks <i>[An additional 66,000 above FYFVMH ambition]</i>	A total of 390,000 people receiving physical health checks <i>[An additional 110,000 above FYFVMH ambition]</i>
Individual Placement and Support (IPS)	16,000 total people accessing IPS <i>[60% Increase in access as per FYFVMH]</i>	20,000 total people accessing IPS <i>[100% increase in access as per FYFVMH]</i>	32,000 total people accessing IPS	44,000 total people accessing IPS	55,000 total people accessing IPS
Early Intervention in Psychosis (EIP)	Achieve 56% EIP Access Standard and 50% Level 3 NICE concordance <i>[FYFVMH commitment]</i>	Achieve 60% EIP Access Standard and 60% Level 3 NICE concordance <i>[FYFVMH commitment]</i>	Maintain 60% EIP Access Standard and 70% Level 3 NICE concordance	Maintain 60% EIP Access Standard and 80% Level 3 NICE concordance	Maintain 60% EIP Access Standard and 95% Level 3 NICE concordance

The new [Community Mental Health Framework](#) describes how the Long Term Plan's vision for integrated primary and community care for adults with SMI can be realised.

£52m

- There is £52m worth of **ringfenced** Mental Health investment to be used for EIP in 2020/21.
- This investment is **not** predicated on savings.
- All areas are expected to use LTP investment for ARMs, over 35s, under 18s and to improve NICE concordance.
- Intelligence from clinical network deep dives has shown that where investment has not grown in line with national uplift, services struggle to meet the quality standard.
- CCG and STP level indicative investment profiles for community SMI and EIP are available

EIP Indicative Allocations 20/21

STP ONS Code	CCG ODS Code	CCG Name	% of national allocation 2020/21	CCG allocation of additional LTP investment in EIP in 2020/21
E54000049	00C	NHS Darlington CCG	0.2%	£103,598
E54000049	00D	NHS Durham Dales, Easington and Sedgefield CCG	0.6%	£309,209
E54000049	00J	NHS North Durham CCG	0.5%	£238,055
E54000049	00K	NHS Hartlepool and Stockton-on-Tees CCG	0.6%	£294,900
E54000049	00L	NHS Northumberland CCG	0.6%	£326,028
E54000049	00M	NHS South Tees CCG	0.6%	£303,963
E54000049	00N	NHS South Tyneside CCG	0.3%	£167,902
E54000049	00P	NHS Sunderland CCG	0.6%	£291,503
E54000005	02N	NHS Airedale, Wharfedale and Craven CCG	0.3%	£147,395
E54000009	02P	NHS Barnsley CCG	0.5%	£254,720
E54000009	02Q	NHS Bassetlaw CCG	0.2%	£111,931
E54000005	02R	NHS Bradford Districts CCG	0.6%	£306,220
E54000005	02T	NHS Calderdale CCG	0.4%	£192,480
E54000005	02W	NHS Bradford City CCG	0.2%	£115,962
E54000009	02X	NHS Doncaster CCG	0.6%	£306,799
E54000006	02Y	NHS East Riding of Yorkshire CCG	0.5%	£281,119
E54000005	03A	NHS Greater Huddersfield CCG	0.4%	£207,296
E54000049	03D	NHS Hambleton, Richmondshire and Whitby CCG	0.2%	£126,993
E54000005	03E	NHS Harrogate and Rural District CCG	0.3%	£134,721
E54000006	03F	NHS Hull CCG	0.5%	£281,781
E54000006	03H	NHS North East Lincolnshire CCG	0.3%	£159,794
E54000005	03J	NHS North Kirklees CCG	0.3%	£168,642
E54000006	03K	NHS North Lincolnshire CCG	0.3%	£161,357
E54000009	03L	NHS Rotherham CCG	0.5%	£246,602
E54000006	03M	NHS Scarborough and Ryedale CCG	0.2%	£116,214
E54000009	03N	NHS Sheffield CCG	1.0%	£509,617
E54000006	03Q	NHS Vale of York CCG	0.5%	£282,120
E54000005	03R	NHS Wakefield CCG	0.7%	£358,247
E54000049	13T	NHS Newcastle Gateshead CCG	1.0%	£498,032
E54000049	99C	NHS North Tyneside CCG	0.4%	£216,635
E54000005	15F	NHS Leeds CCG	1.5%	£759,188

Key Messages for EIP

- We are beginning to see increased acuity in presentations to our services.
- We must use the Phase 3 planning process to ensure we invest across the entire health pathway, and not just in beds. This means investment in alternatives to admission and strengthening and investing in community services.
- The role of digital transformation must be a central feature of this planning exercise as it offers a major opportunity to modernise care. However, in many cases, it should not be a replacement for face-to-face support.
- As of Q2 2020/21, national assurance activity and data collections will resume with performance being discussed in the quarterly deep dives.
- Systems are required to triangulate activity, finance and workforce trajectories and produced a plan that is feasible in the post-pandemic context.
- Workforce growth remains the key enabler.
- This is how we will transform the quality and reach of mental health care in this country.

Planning

Team	CCG(s)	19/20 NCAP	Trajectory		Funding gap identified (2019 Q1 review)	Funding provided since the Q1 review	CCG share of 20/21 ring-fenced funding	20/21 Investment plan	Gap/surplus	Funding for gap in LTP plan?	Notes
			20/21	23/24							
Example	Example	Level 2	Level 2	Level 3	£250k	Nil	£300k	£290k	+£10k	N/A	Level 3 trajectory is dependent on planned workforce investment and the establishment of an ARMS pathway. CCG have provided additional funding for increased demand following C-19 outbreak

Team	CCG(s)	19/20 NCAP	Trajectory		Funding gap identified (2019 Q1 review)	Funding provided since the Q1 review	CCG share of 20/21 ring- fenced funding	20/21 Invest- ment plan	Gap/ surplus	Funding for gap in LTP plan?	Notes
			20/ 21	23/ 24							
Example	Example	Level 2	Level 2	Level 2	£990k	Nil	£340k	£490k	- £500k	No	Level 3 trajectory is dependent on workforce investment beyond that which is currently planned. An ARMS pathway is required and a 3-year programme for over 35s.

North East and Yorkshire and the Humber Adult Mental Health
Clinical Network

Early Intervention in Psychosis Network

**Introduction to the Group Discussion:
Peer Workers and Increasing Service User and Carer
Participation in EIP**

**Dr Steve Wright, Co-Chair, Consultant Psychiatrist, TEWV & Clinical
Advisor, Y&H Clinical Network**

17 September 2020



Early Intervention in Psychosis
Achieving *Ordinary Lives*

NHS England and NHS Improvement



Service User & Carer Involvement

- What is the purpose?
- What are the expectations?
- Representation
- Peer support
- Coproduction (in it's widest sense)
- Lived experience leadership
- Peer-led services

Arnstein's ladder of citizen participation

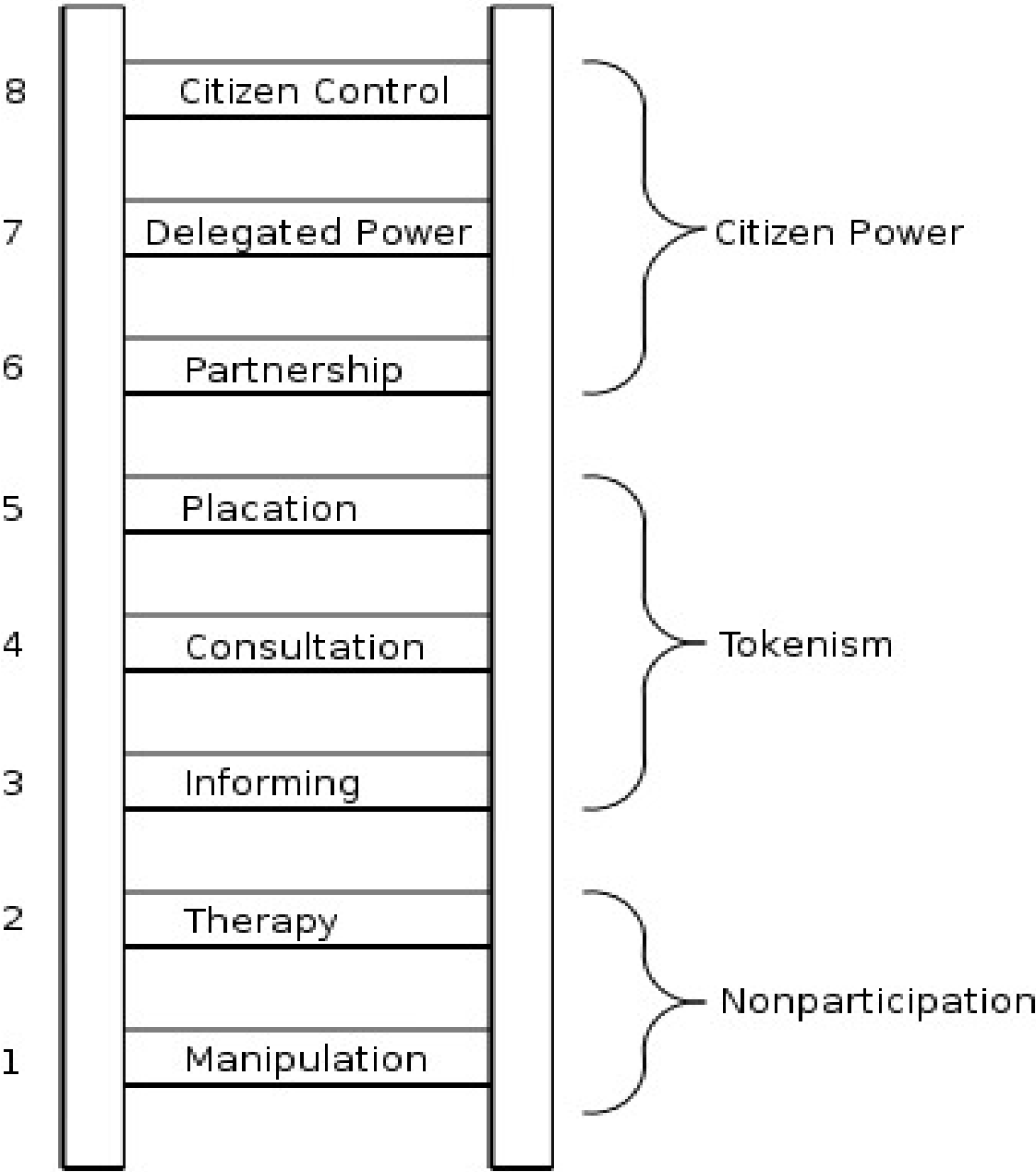

Growing Peer Support Worker Numbers

The Mental Health Implementation Plan identifies opportunities for the growth of PSWs up until 2024 across the following areas: Perinatal Mental Health, **Adult Severe Mental Illnesses (SMI) Community Care**, Adult Crisis Alternatives, and Problem Gambling Mental Health Support. Health Education England is committed to growing the PSW workforce within these areas, and within any other area of mental health where a perceived need exists. Our ambition is to support the development of 4,730 PSWs nationally by 2023/24, and to grow PSW supervisor capacity and capability in line with the ambitions in the Mental Health Implementation Plan.

To support the above, we are putting a call out for expressions of interest from local systems and service providers who are interested in becoming a PSW trailblazer this year. At the same time, we are also interested in scoping out the existing demand for PSW and PSW supervisor training.

To register your interest and responses in PSW and PSW supervision training please follow the below survey links:

- Demand survey: the PSW and PSW supervision training demand survey can be found at: <https://healtheducationyh.onlinesurveys.ac.uk/psw-training-demand> with the deadline of **Wednesday 30th September 2020 COP**. Please ensure to read the survey introduction carefully before filling in the survey.
- The trailblazer expression of interest survey: the PSW trailblazer demand survey can be found at: <https://healtheducationyh.onlinesurveys.ac.uk/psw-eoi-trailblazer> with the deadline of **Monday 21st September 2020 COP**. Please ensure to read the survey introduction carefully before filling in the survey.

North East and Yorkshire and the Humber Adult Mental Health
Clinical Network

Early Intervention in Psychosis Network

Slido Session!

Open: www.slido.com
Enter code: #YHEIP

17 September 2020



Early Intervention in Psychosis
Achieving *Ordinary Lives*

NHS England and NHS Improvement



Slido



At today's meeting we are going to use Slido to allow people to take part in interactive polls.

You just need to follow a two easy steps and then you will be ready to participate:

1. In the internet browser on your phone, tablet or laptop open: www.slido.com
2. Enter code: #YHEIP

North East and Yorkshire and the Humber Adult Mental Health
Clinical Network

Early Intervention in Psychosis Network

Thank you for attending!

17 September 2020



Early Intervention in Psychosis
Achieving *Ordinary Lives*

NHS England and NHS Improvement

