

Yorkshire and the Humber Adult Mental Health
Clinical Network

Early Intervention in Psychosis Network

EIP and COVID-19 Sharing Webinar

5 June 2020



Early Intervention in Psychosis
Achieving *Ordinary Lives*

NHS England and NHS Improvement



Housekeeping

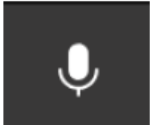

Please remain on mute throughout the session, unless invited to speak – thank you.



You are welcome to use the video function, however this occasionally causes bandwidth problems so you may wish to turn it off.

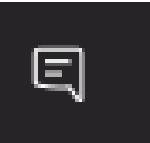

Whilst we will have an open conversation, please *feel free to use the chat box function* to ask questions or make comments.

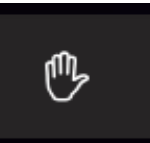

If you would like to speak please use the “Put Hand Up” function and the moderator will come to you in due course.

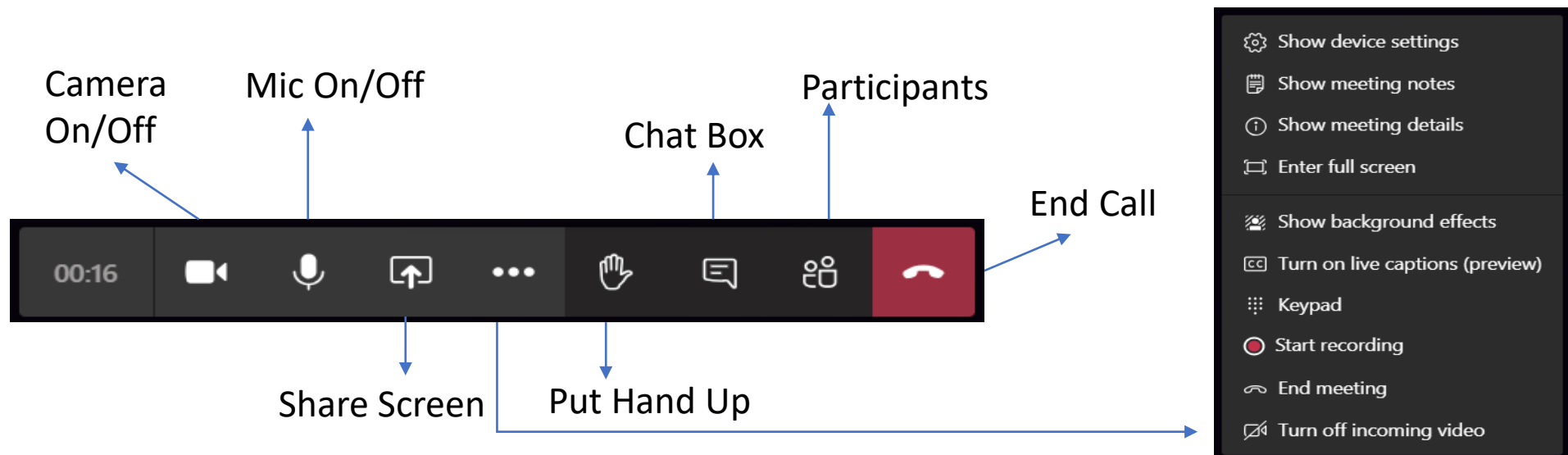

Updates from teams

- Good practice - (NHSE/I Webinar 11-12:30 16th June 2020)
- Recovery plans
- Digital / F2F / Choice
- Changes in demand in May? Pathways? Acuity? DUP?
- Family work and carer support
- Trauma (NHSE/I webinar tbc)
- BAME issues (service users and staff) (NHSE/I webinar tbc)
- What support is needed?

Key principles for delivering EIP in the context of COVID 19

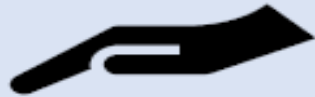

Individuals with psychosis are some of the **most vulnerable members of society**. A concerted effort should be made to ensure that individuals, their families and carers **receive the care and support they need to support recovery, prevent relapse and lead fulfilling lives**



It is **vital that critical core community service are maintained during the pandemic** and any changes made to service configurations are reviewed regularly with the view to restoring to full service provision at the earliest possible opportunity



Where it is not possible to provide face to face interventions safely, EIP teams should provide **interventions and support digitally**

Individuals with psychosis are some of the most vulnerable members of society, and a concerted effort should be made to provide safe and appropriate care in the context of covid-19



Key principles: EIP delivery in the context of COVID-19

1



A concerted effort should be made to ensure that individuals, their families and carers **receive the care and support they need to support recovery, prevent relapse and lead fulfilling lives**

2



It is **vital that critical core community service are maintained during the pandemic** and any changes made to service configurations are reviewed regularly with the view to restoring to full service provision at the earliest possible opportunity

3



Where it is not possible to provide face to face interventions safely, EIP teams should provide **interventions and support digitally**

4



People with psychosis have key physical health needs that must be met during this time and we must not lose sight of the initial progress that has been made to address health inequalities.

Cross-cutting

- Data and reporting – submitting data to MHSDS for two-week waiting time standard
- Sharing good practice
- Co-production and engagement

Regional Programme & Feedback from National Meeting

National Team Meeting with Regional Leads 05-06-20

- NCAP 19/20 and 2020/21
- New Commissioning Guideline – late summer publication
- ARMS guidance (NB- request for CAARMS training)
- ARMS, Trauma & LTP
- Forthcoming webinars 16 June: Safe F2F – need volunteers for good practice examples
- Proposed webinars: Trauma and Psychosis; BAME and Psychosis
- National team has asked for feedback about any planned funding for EIP being put on hold or cancelled

Q2 Regional Programme

- LTP refresh, MHIS and Clare Murdoch letter
- RTT, improvement programmes and assurance
- Preparing for 'surge' (WM Demand Tool)
- 19/20 NCAP results
- Contracting
- Steering groups
- Matrix/Dashboard (inc. Triangulation and Snomed)

EIP Matrix Dashboard

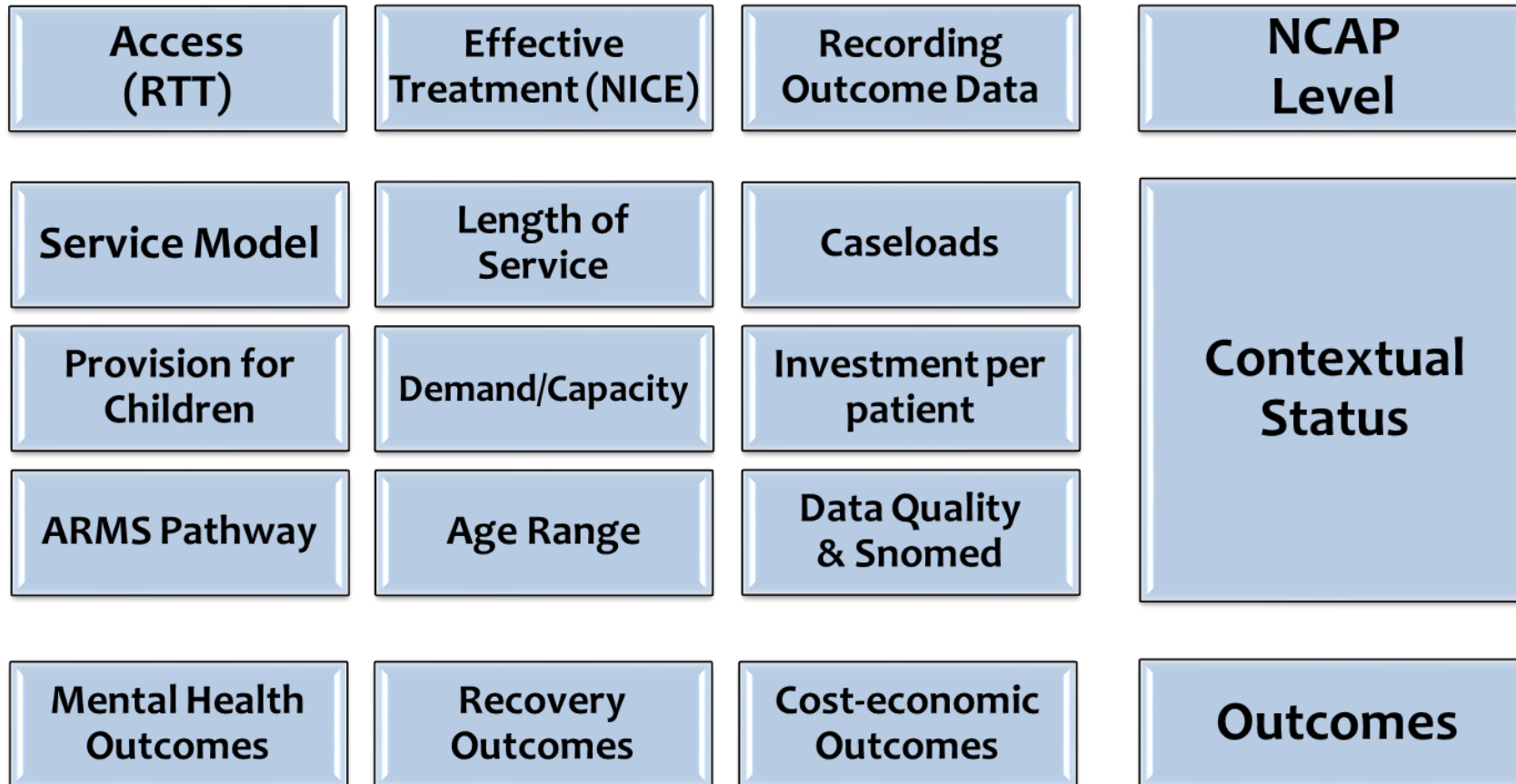

EIP Matrix Dashboard – example

| | | | |
|---|------------------------------------|---|------------------------------------|
| Access 84% | NICE Level 3 | Outcome Data Level 2 | NCAP Level 3 |
| Service Model Stand Alone MDT | 3-Year Service 40 months | Caseloads 15 | Contextual Status |
| Provision for Children | Demand/Capacity 225/185 | Investment £7,450 | |
| ARMS Pathway | Age Range 14-65 | Data Quality & Snomed | |
| Mental Health Outcomes | Recovery Outcomes | Cost-economic Outcomes | |

System Support

Recent webinars and how to view them

- Physical health (NHSE)
- Digital delivery (NHSE)
- Trauma informed care (NHSE)
- Outcomes (NCAP)

Forthcoming webinars

- F2F
- NCAP webinars
- EIPN forum

Information and discussion forums

- Future NHS Platform
- IRIS
- RCP C-19 MH improvement network

Training

- Latest from HEE and demand mapping
- Meriden virtual BFT

Future Meetings

<http://iris-initiative.org.uk/>



Latest additions to the C-19 resource section:

- Delivering Family Interventions during C-19 (Meriden)
- Equally Well: Physical Health support for people with SMI (CMH/Rethink)
- C-19 resources from IEPA and Greater Manchester Health & Social Care Partnership

Early Intervention in Psychosis Network (EIPN) Fifth Annual Forum



“Starting at the Beginning: Reclaiming *Early Intervention*”

Tuesday 30 June 2020, 10.30 – 14:50

An online forum, conducted using Microsoft Teams Live

**Please note that this event is split into a morning session and afternoon session.
Each session has a different link to attend the event.**

[Click this link to attend the morning session](#)

[Click this link to attend the afternoon session](#)

